

# 安装使用说明书

## INSTALLATION INSTRUCTIONS

www.moen.cn

2# 十字螺丝刀  
2# Phillips  
Screwdriver

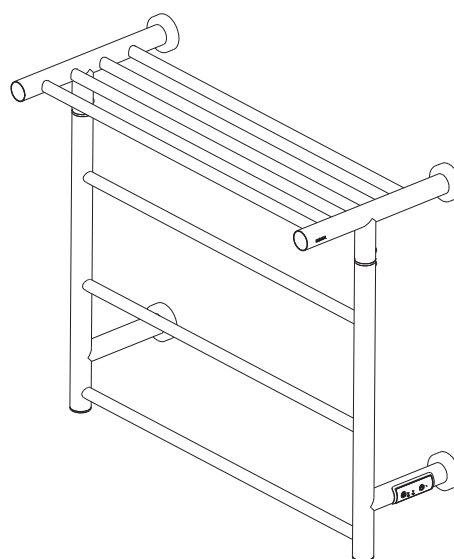

Record Purchased Model Number:  
(Save instruction sheet for future reference)



清单B List B ( ACC2506BL/ACC2506BG/ACC2506CW )

部件编号 No.	名称 Description
A 	塑料膨胀管 x8 Plastic Expansion Tube x8
B 	自攻螺钉 x8 Self-tapping Screw x8
C 	内六角扳手 Allen Key

产品规格 Product Specification

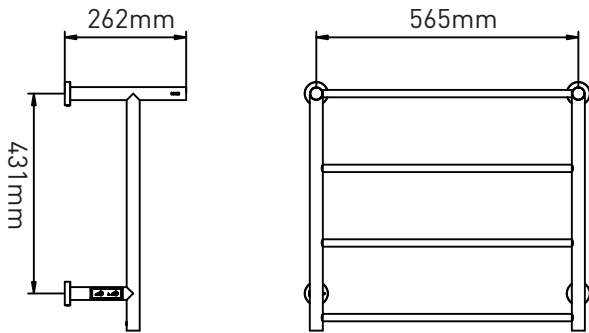

产品型号 Product Model	额定输入电源 Rated Input Power Supply	功率 Power
ACC2506/ACC2506MCL/ACC2506BG	220V~ 50Hz	80W
ACC2506BL/ACC2506CW	220V~ 50Hz	125W

注意：产品为暗装款，产品自带电源线，长度为800mm，需提前预留穿线管及开关盒。

Note: The product is a concealed version, the length of the product's own power cord is 800mm, and the threading tube and switch box must be reserved in advance.

安装完成示意图 Installation Complete Diagram

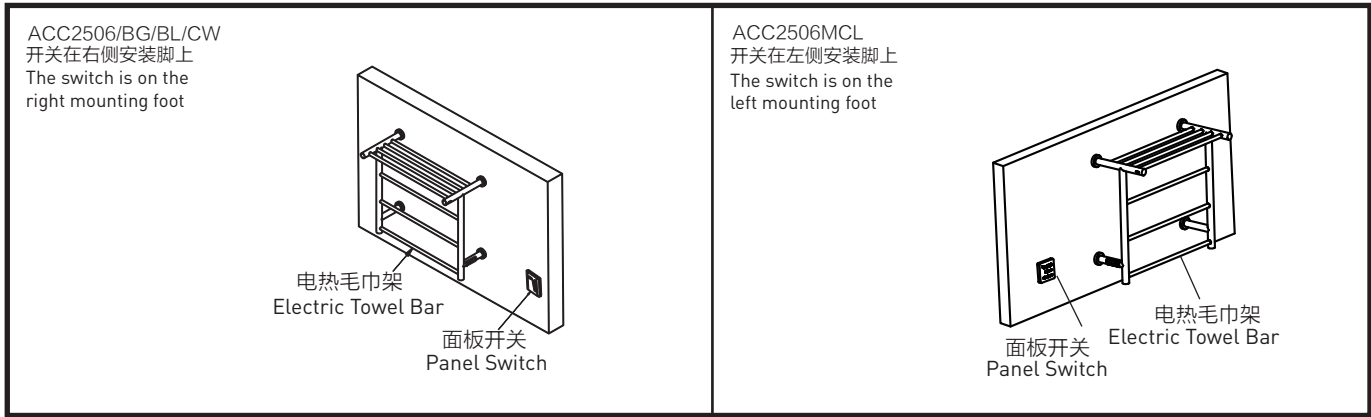

为了您的使用安全和产品正常运行，请将毛巾架和面板开关安装在卫生间的干区，特别注意需避免水滴溅入开关内部，并且确保毛巾架最低杆离地面距离不小于600mm。

For your safety and normal operation, please install the towel rail and panel switch in the dry area of the bathroom, pay special attention to avoid water droplets splashing into the switch, and ensure that the minimum distance between the towel rack and the ground is not less than 600mm.

## 安装步骤 Installation Steps

- 清单A安装步骤: 1-2A-3-4-5-6-7-8
- 清单B安装步骤: 1-2B-3-4-5-6-7-8

1

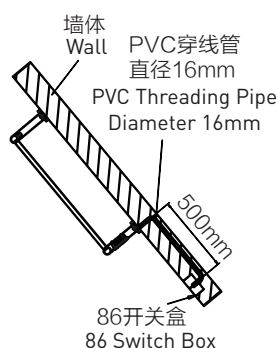

确定安装位置后，在产品的开关安装脚处预埋PVC穿线管；在预计安装漏电保护处预埋标准86开关。

**注意：**PVC不应突出墙面。

After determining the installation position, install the PVC threading pipe on the switch mounting foot of the electric towel bar; install the 86 switch in the leakage protection place.

**Note:** The PVC threading pipe should not be extend beyond the wall.

2A

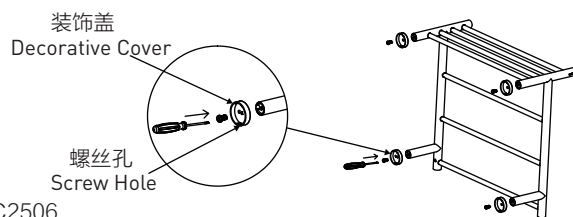

ACC2506

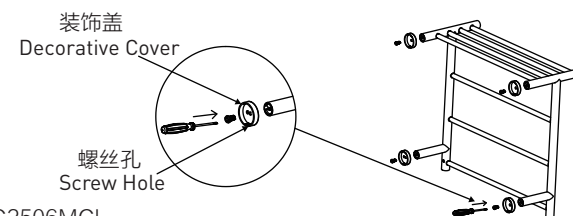

ACC2506MCL

取出安装脚中已预装的紧定螺钉，将毛巾架上的线缆穿过双孔装饰盖中偏上的孔洞。用平头螺钉将装饰盖安装到毛巾架脚上。

**注意：**装饰盖侧面的螺丝孔朝向地面。

Remove the pre-installed set screws in the mounting feet and route the cables from the towel bar through the upper holes in the double-hole decorative cover. Install the decorative cover to the towel bar feet with the flat head screws. **Note:** The screw holes on the side of the decorative cover should face the ground.

3

ACC2506/BL/BG/CW

三孔底座在毛巾杆  
右下方安装  
The three-hole base is  
installed at the bottom  
right of the towel bar



ACC2506MCL

三孔底座在毛巾杆  
左下方安装  
The three-hole base is  
installed at the bottom  
left of the towel bar

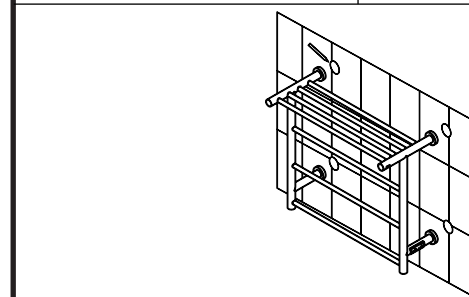

2B

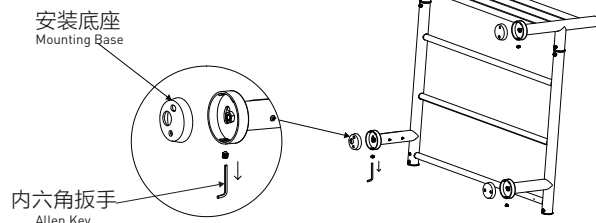

拧下紧定螺钉，将安装底座从毛巾架上取下。

Unscrewed the set screw, the installed base from the towel rack.

a. 请根据购买的型号，将三孔安装底座带孔洞的一面，如图所示，靠在墙上，中间圆孔与PVC穿线孔重合，在底座轮廓圈内用铅笔或记号笔画出安装孔轮廓。

b. 将三孔底座安装好后（可参考第六、七步），把毛巾架放到准备安装的墙面，用铅笔或记号笔在墙上画出安装脚装饰盖的轮廓。

a. Please place the hole side of the three-hole mounting base against the wall as shown in the picture according to the model you purchased, with the middle round hole overlapping the PVC threading hole, and draw the outline of the mounting hole with a pencil or marker in the contour circle of the mounting base.

b. Once the three-hole base is installed [Refer to step 6 and 7], place the towel bar on the wall to be installed, and use a pencil or marker to outline the mounting foot decorative cover on the wall.

4

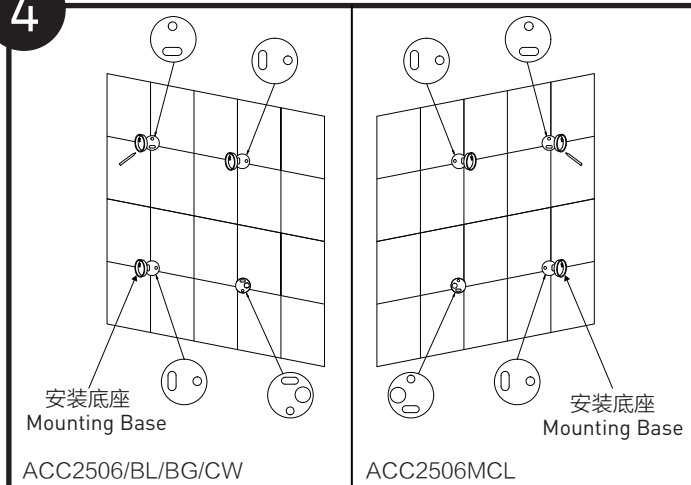

取剩下的安装底座小端靠墙，在安装脚轮廓圈内用铅笔或记号笔画出安装孔轮廓。

**注意：**请按图将螺丝孔位错位摆放。

Take the small end of the mounting base against the wall, and draw the outline of the mounting hole with a pencil or a marker inside the contour circle of the mounting foot.

**Note:** Please install the plug hole in dislocation as shown in the figure.

5

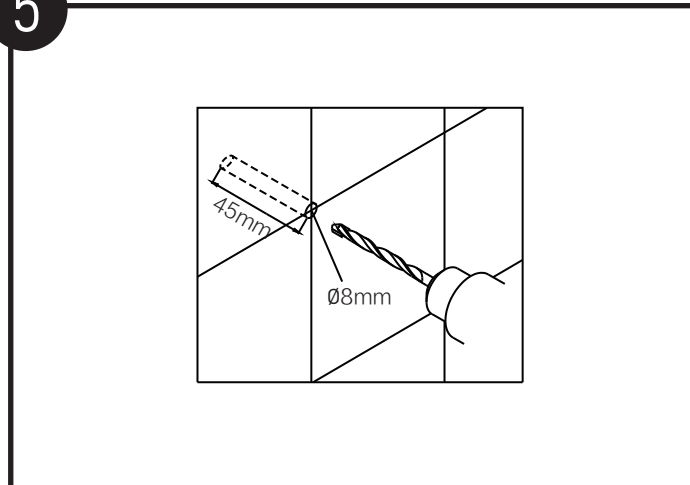

在画出的轮廓处钻直径8mm，深45mm的安装孔，并打入塑料膨胀管。

Drill a mounting hole with a diameter of 8mm and a depth of 45mm at the drawn outline, and drive into the plastic expansion tube.

6

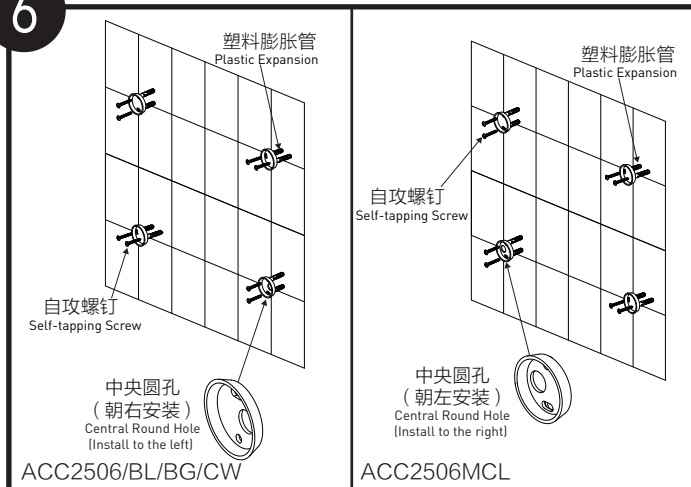

在孔内打入塑料膨胀管后，用自攻螺钉将底座上紧并固定在墙上。

**注意：**请按图将螺丝孔位错位摆放。

Drive a plastic expansion tube into the hole, tighten the base with self-tapping screws and fix it on the wall.

**Note:** Please place the screw holes in a misplaced position according to the picture.

7

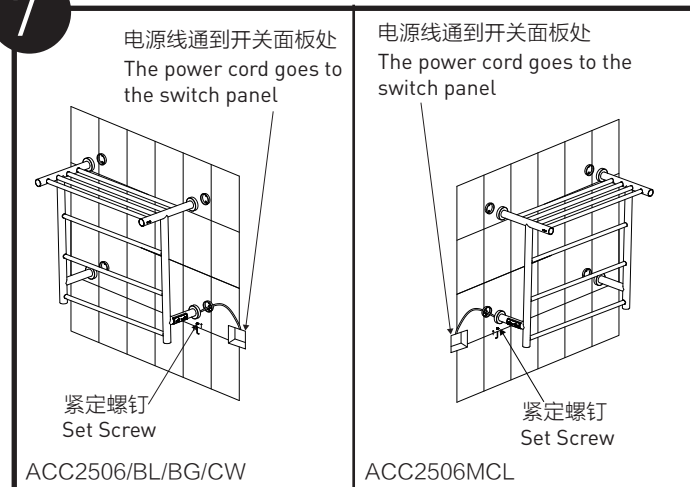

将电源线通过底座圆孔穿入PVC穿线管并到达预埋开关盒，后使用紧定螺钉将产品安装在底座上，并上紧。

Pass the power cord through the round hole of the base into the PVC conduit and reach the embedded switch box, then use the set screw to install the product on the base and tighten it.

Figure 1 illustrates the installation of the control panel. The left diagram shows the control panel being inserted into a slot in the wall. The right diagram shows the control panel fully installed and secured with screws. Labels in Chinese and English point to the 'Control Panel'.

Refer to the installation instructions of the panel switch to connect the power cord and tighten the panel switch to the switch box.  
After the installation, check if the product is installed firmly and the power cord is correctly connected before product power on.

## 控制面板操作说明 Panel Operation Instructions

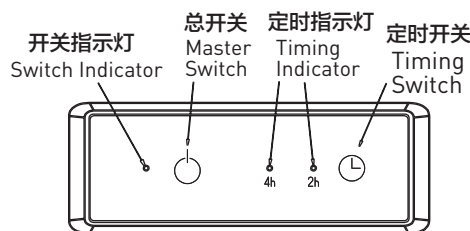

## 电源开关

- 按下电源开关，开关指示灯亮，毛巾架进入常开加热模式。

## Power Switch

Press the power switch, the switch indicator light is on, the towel bar enters the heating mode.

## 定时开关

- 开关为循环切换模式，4h/2h循环选择；切换到4h模式时，4h定时指示灯亮，产品加热4小时后，电源自动关闭，加热停止；切换至2h模式时，2h定时指示灯亮，产品加热2h后，电源自动关闭，加热停止。
- 开关具有温控功能，温控范围45~55℃，可防止温度过高导致烫伤。

## Timing Switch

- The switch is in cycle switching mode. It has 4h/2h cycle selection. When selecting 4h mode, the 4h timing indicator light is on. After the product is heated for 4 hours, the power is automatically turned off and the heating stops. When selecting 2h mode, the 2h timing indicator light is on. After the product is heated for 2h, the power is automatically turned off and heating stops.
- The switch has a temperature control function, the temperature control range is 45°C~55°C, which can prevent the temperature from being too high and cause scald.

# 有害物质名称及含量

## 中国有害物质声明

为满足中国电子电气产品有害物质限制相关的法律法规和其它要求，我司经过内部详细排查后，按部件分类，声明如下：

# Harmful Substances and Content

## China Hazardous Substances Declaration

In order to meet the laws, regulations and other requirements related to the restriction of hazardous substances in electrical and electronic products in China, our company declares as follows:

部件 Component	有害物质 Hazardous Substances					
	铅 (Pb)	汞 (Hg)	镉 (Cd)	六价铬 (Cr(VI))	多溴联苯 (PBB)	多溴二苯醚 (PBDE)
塑料件 Plastic Parts	○	○	○	○	○	○
配件 Attachment	○	○	○	○	○	○
金属件 Metal Part	○	○	○	○	○	○
时控开关组件 Switch assembly	×	○	○	○	○	○
发热元件 Heating Element	×	○	○	○	○	○

本表格依据SJ/T 11364的规定编制。某些型号的产品可能不包含表中的部分部件，电控板组件包含元器件、PCB、接线端子等。

备注：

O：表示该有害物质在该部件所有均质材料中的含量均在GB/T 26572规定的限量要求以下。

X：表示该有害物质至少在该部件的某一均质材料中的含量超出GB/T 26572规定的限量要求。标记“X”的部件，皆因行业技术发展水平限制而无法实现有害物质的替代。

This form is compiled in accordance with the provisions of SJ/T 11364. Some models of products may not contain some parts in the table, and the electric control board assembly includes components, PCB, terminal blocks, etc.  
Remarks:

O: Indicates that the content of the hazardous substance in all homogeneous materials of the part is below the limit requirement specified in GB/T 26572.

X: Indicates that the content of the hazardous substance in at least one of the homogeneous materials of the part exceeds the limit requirement of GB/T 26572. The parts marked with "X" cannot be replaced by hazardous substances due to the limitation of the technological development level of the industry.



圆圈内的数字表示正常使用状态下产品的环保使用期限。



The number in the circle indicates the environmental protection use period of the product under normal use.



## 产品售后保修条款

摩恩产品是在高质量标准及生产工艺下制造的，摩恩承诺为消费者购买的洁具产品提供有期限免费保修及终身维修服务。

电热毛巾架免费保修期为1年，均自消费者购买日（以摩恩产品分销商开具的发票或收据上载明日期为准）起计。

免费保修范围为产品及产品配件由于材质及工艺原因而造成的故障或损坏。免费保修期内，我们将无偿为您提供修理服务及更换发生故障的产品或产品配件。摩恩的售后服务责任仅限于对故障产品的修理，而不延及您因产品故障而发生的其他损失，法律另有规定的除外。

您需了解：产品外观碰伤、刻划痕迹，以及滥用及不正当保养所导致的故障或损坏，均不属于免费保修范围。即使在免费保修期内，属下列（1）-（5）情况之一的，需酌情收取修理费用：

1. 不能出示相符的保修卡和有效购买凭证情况的，
2. 未按使用说明书告知的使用方法和注意事项造成的故障，
3. 自行拆卸、维修、改装所造成的故障和损坏，
4. 由于不可抗力等外部原因引起的故障和损坏，
5. 由于运输、搬运、挤压等造成的损坏。

对于保修期外或不在保修范围内的产品，如需维修，摩恩将酌情收取上门费、人工费及材料费。本保修条款仅对原始消费者和酒店行业的购买者有效，并不适用于本产品工业，商业，贸易和非酒店行业的使用。

如对本保修条款内容有任何疑问，请拨打400 630 8866 咨询热线，或向当地分销商咨询。

## MOEN LIMITED WARRANTY

We offer limited warranty and lifetime maintenance for Moen products, which are all manufactured with high standards of workmanship.

The period of warranty shall start from the date of purchase of the product (according to the invoice or receipt issued by Moen distributors) and shall cover a period of the following: the warranty period for electric towel bar is 1 year.

This warranty is your coverage against material and workmanship malfunction or defects in Moen products or components. During the warranty period, we offer free maintenance and changing of malfunctioned products or product components. Moen's after sales service liability is limited to the maintenance of faulty items and does not cover your other losses caused by product malfunction, except for otherwise stipulated by law.

Cosmetic damages (scratches, dents, etc.) and malfunction or defects caused by abuse or improper maintenance is not covered by this warranty. Although the warranty period remains valid, in case of the following conditions (1) - (5), the maintenance cost (material cost and labor cost) shall still be charged as the case may be:

1. Corresponding warranty card and valid invoice cannot be presented;
2. Faults were caused by the incompliance with the instructions and precautions provided in the user's manual;
3. Damages and faults were caused by self-actuated dismantling, repair and refit;
4. Faults and damages were caused by external factors such as force majeure;
5. Damages were caused by transportation, unloading and extrusion, etc.

This warranty is valid for the original consumers only (including hotel use), and excludes industrial and commercial use of the product (except for hotel use). This card is only responsible for product maintenance rather than any other liabilities.

In the event that the product requires maintenance but exceeds the warranty period, or that the product is not covered by this warranty, labor cost and material cost shall be charged as the case may be.

Please call 400-630-8866 or contact local dealer for any question.

<b>MOEN® 摩恩</b>	
合 格 证	
Compliance Certification	
电加热不锈钢毛巾架	
产品名称	Electric Heating Stainless Steel Towel Rack
Product Name	
检验员	
Inspector	
生产日期	
Date of Production	
富俊汇赢科技（上海）有限公司	
中国（上海）自由贸易试验区新杨公路	
1800弄1号4幢207室	
邮编：201413	
Fortune Brands Innovations (Shanghai) Co., Ltd	
Room 207, Building 4, No.1, Lane 1800, Xinyang Highway,	
China (Shanghai) Pilot Free Trade Zone	