

MOEN® 摩恩

SPECIFICATIONS

DESCRIPTION

- Product Specifications: 218 x 160 x 114mm
- Metal construction with various finishes identified by suffix
- G1/2 connections
- Includes 5F hand-held shower and 1500mm long hose

OPERATION

- Pull-on / Push-off
- Temperature controlled through 90 degree arc of handle travel
- Lever style handle

FLOW

- Tub position: Water flowrate 6.0 L/min minimum at 0.1Mpa
- Shower position: 4.0 L/min to 9.0 L/min at 0.1Mpa with shower attached

CARTRIDGE

- Ceramic 35mm cartridge design
- Ceramic material

STANDARDS

- Designed to meet GB 18145; GB28378

WARRANTY

- 5 years limited warranty against leaks and drips

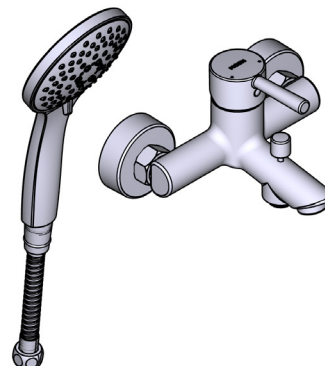

Single Handle Wall Mount Tub Shower Faucet

MODELS: 99132 series

