

MOEN® 摩恩

淋浴杆 安装说明书

Shower Bar

INSTALLATION INSTRUCTIONS

如需安装支持，配件丢失等，请联系MOEN。
(中国) 400-630-8866
www.moen.cn

PLEASE CONTACT MOEN FIRST
For Installation Help, Missing or Replacement
Parts
(China) 400-630-8866
www.moen.cn

推荐工具

为了安全和让安装和替换变得容易，Moen建议您使用以下工具：

HELPFUL TOOLS

For safety and ease of replacement, Moen recommends the use of these helpful tools.

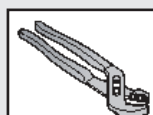

可调钳
Adjustable Pliers

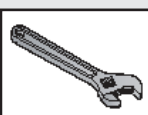

活动扳手
Adjustable Wrench

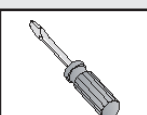

一字螺丝刀
Flathead Screwdriver

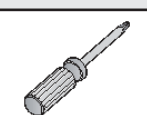

十字螺丝刀
Phillips Screwdriver

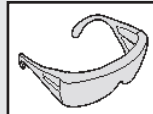

护目镜
Safety Glasses

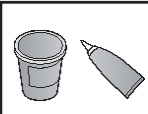

密封胶
Sealant

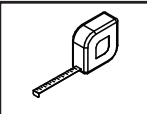

卷尺
Tape Measure

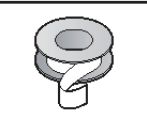

螺纹密封带
Thread Seal Tape

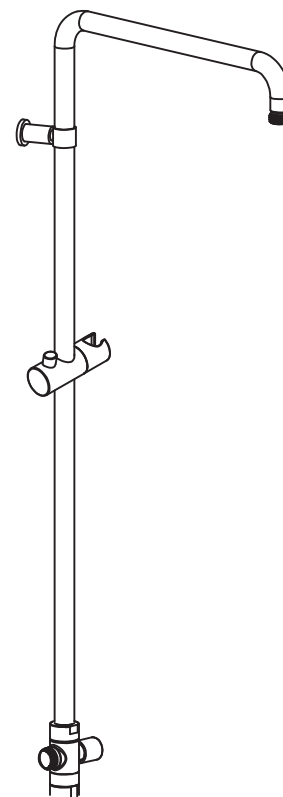

2276 系列
2276 Series

图片仅供参考
(款式因型号而异)

Image is for reference only
(Style varies by model)

记录购买的型号：
(保存安装说明书以备将来参考)

Record Purchased Model Number:
(Save instruction sheet for future reference)

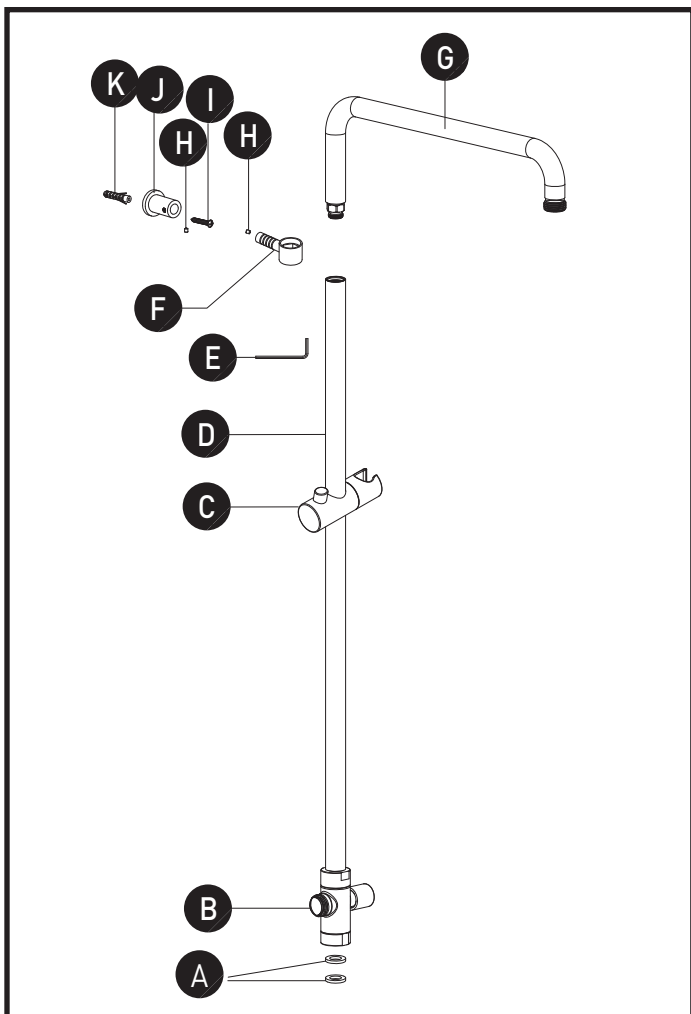

零件清单

- A. 密封垫片
- B. 切换阀
- C. 滑座
- D. 直管
- E. 内六角扳手
- F. 调节杆
- G. 弯管
- H. 紧固螺钉
- I. 自攻螺钉
- J. 固定座
- K. 膨胀管

Parts List

- A. Washer
- B. Diverter
- C. Slider
- D. Tube
- E. Allen Wrench
- F. Join
- G. Shower Arm
- H. Fixing Screw
- I. Self-tapping Screw
- J. Fixing Ring
- K. Screw Chassis

安装前注意事项 Precautions before Installation



警告：在墙上钻任何孔时，请确保在您准备钻孔的地方没有隐蔽的管道和线缆！

申明：本公司保留更改产品结构不另行通知的权利。

- 本产品已经出厂检测及调试，请勿自行拆卸。
- 安装前，请务必先清除墙体预埋水管内的杂质及污泥，以免影响出水功能。
- 本产品的工作压力：0.05MPa~0.6MPa。
推荐工作压力：0.2MPa~0.5MPa。

Warning: Please make sure there are no hidden service pipes or cables where to drill the wall.

Declare: We hereby reserve the rights to amend the specication without prior notication.

- The product has passed functionality tests before sale, do not disassemble the product by yourself.
- Clear your plumbing to avoid any debris from impacting on product performance.
- The working pressure of this product is 0.05MPa to 0.6MPa.
The recommended working pressure is 0.2MPa to 0.5Mpa.

1

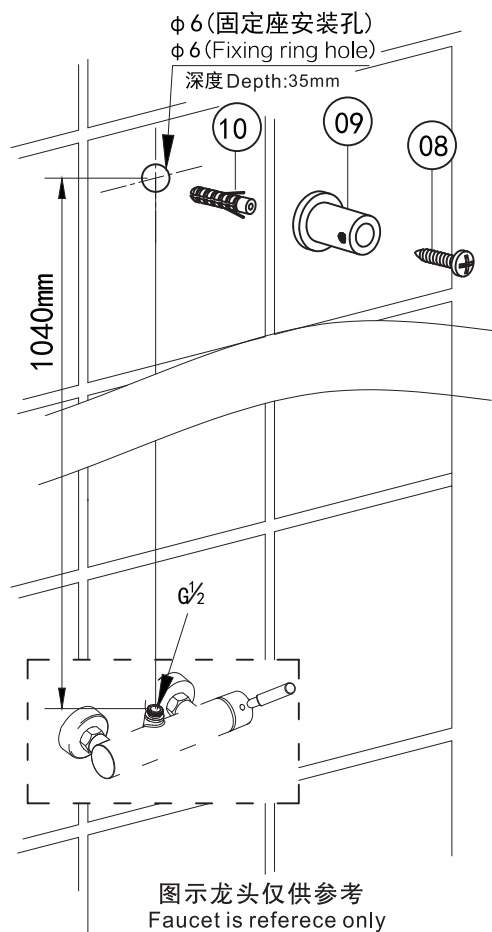

钻固定座安装孔

1. 依参考图示，在墙上划线 [距离1040mm可根据实际情况通过截短直杆（04）进行调节]。
2. 用钻头在墙上钻1个直径6mm的固定座安装孔，孔深35mm。

安装固定座

1. 在安装孔内打入膨胀管（10），注意不要露出墙面，然后用自攻螺钉（08）将固定座（09）固定在墙上安装孔处。
2. 调整固定座（09）与淋浴龙头出水口距离至1040mm，锁紧自攻螺钉（08），将固定座紧固在墙上。

Drill the fixing ring hole

1. As left figure, mark the fixing ring hole on the wall. [the 1040mm distance may be adjusted by cutting tube (04) according to the situation]
2. Drill one $\Phi 6$ mm hole in the wall. The depth of hole should be 35mm.

Install the fixing ring

1. Insert the screw chassis (10) into the hole without extrusion then locate the fixing ring (09) onto the wall with the self-tapping screw (08).
2. Adjust the distance between fixing ring (09) and outlet of faucet to be 1040mm. Tighten fixing ring on the wall.

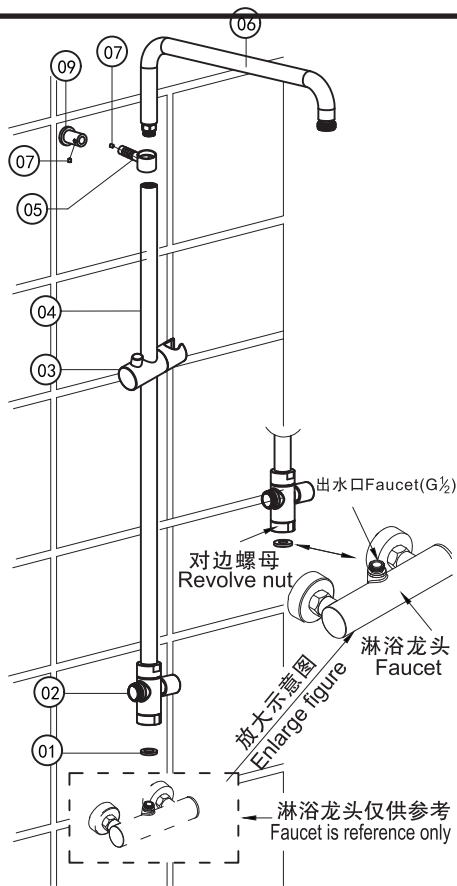

1. 将花洒支(06)上有六方的一端套在调节柱(05)的六方内,如图示,注意(06)的方向。再将紧固螺钉(07)从(05)的内孔拧进去,用内六角扳手拧紧;
2. 取直杆(04)组件,无切换阀端与(06)花洒支臂有六方的一端螺纹连接,用手拧紧,确保不渗漏;
3. 在切换阀(02)下面的对边螺母内放入密封垫片(01),使对边螺母与淋浴龙头出水口G1/2螺纹相连接,暂不锁紧;
4. 调整直杆(04),[直杆(04)相对切换阀(02)可根据需要进行微调]使调节杆(05)尾部顺利套入固定座(09),直杆(04)与墙面平行。从调节杆(05)侧面螺纹孔旋入紧固螺钉(07),并用内六角扳手拧紧。
5. 用扳手锁紧切换阀(02)下面的对边螺母,确保不渗漏。

1. Insert the hexagonal of shower arm(06) into hexagonal of joint(05),as left figure. Then insert fixing screw(07) into joint(05) and tighten.
2. Screw the tube assemble(04)end without diverter valve,connect shower arm end with hexagon(06)and tighten.
3. Put one washer(01)into the revolve nut of diverter valve(02),connect the nut with the outlet G1/2 gage of faucet, not tighten.
4. Adjust the tube(04),[tube(04)may be adjusted up and down a little bit versus(02)] insert the end of joint(05)into fixing finger(09) to ensure it parallel with the wall,put the fixing screw(07)into the side of joint(05) and tighten.
5. Tighten the revolve nut of diverter valve(02),make sure not leaking.

安装其它卫浴配件 (仅供参考)

Install other parts (for reference only)

3

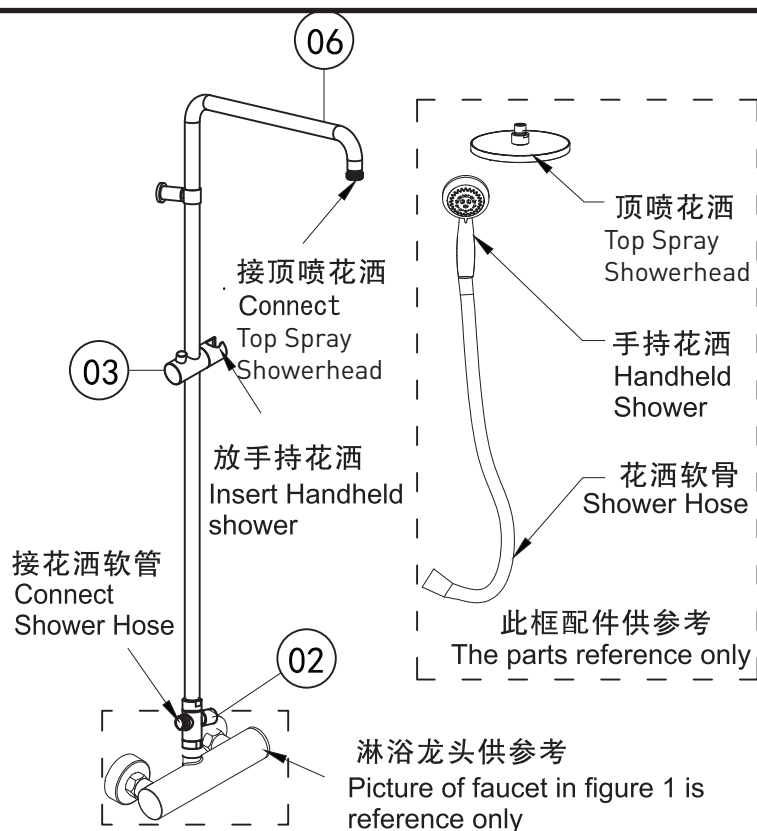

警告：当您使用本产品进行淋浴时，请先开启冷水然后再开启热水，已免烫伤！

When using bar shower, please turn on the cold water at first, which can efficiently avoid burning accident.

使用说明

切换阀（02）的使用方法

切换阀控制手持花洒与顶喷花洒之间的出水切换。

- 将切换阀（02）把手向外拉，手持花洒出水。
- 将切换阀（02）把手向里压，顶喷花洒出水。

按下滑座（03）的按钮，可依据自己的要求调整滑座高度。

Use Instructions

Usage of Diverter Valve (02)

The Diverter Valve (02) controls the outlet types.

- Pull up the Diverter Valve handle, the water sprays from the handheld shower.
- Press down the Diverter Valve handle, the water sprays from top shower head.

Press down the slider (03) button, adjust the height of the slider to meet your demand.

清洁护理

- 为保持淋浴器洁净，请定期清洁。
- 先用清水或温和的液体清洁剂清洗，然后用清水冲洗，再用软棉布抹干。
- 切勿使用任何具有酸性和研磨作用的清洁剂。
- 禁止使用钢丝球、钢丝刷等硬质物品清洗，以免划伤产品外表面。

Maintenance

- Keep the product clean with clean water or mild liquid detergent regularly.
- Rinse with clean water, and dry the surface with a soft cotton.
- Do not use acid or abrasive detergents.
- Do not use hard materials (for example, steel wool, scourer etc.) to clean the product.

产品售后保修条款

摩恩产品是在高质量标准及生产工艺下制造的，摩恩承诺为消费者购买的洁具产品提供有期限免费保修及终身维修服务。

淋浴杆免费保修期为1年有限。均自消费者购买日（以摩恩产品分销商开具的发票或收据上载明日期为准）起计。

免费保修范围为产品及产品配件由于材质及工艺原因而造成的故障或损坏。免费保修期内，我们将无偿为您提供修理服务及更换发生故障的产品或产品配件。摩恩的售后服务责任仅限于对故障产品的修理，而不延及您因产品故障而发生的其他损失，法律另有规定的除外。

您需了解：产品外观碰伤、刻划痕迹，以及滥用及不正当保养所导致的故障或损坏，均不属于免费保修范围。即使在免费保修期内，属下列（1）-（5）情况之一的，需酌情收取修理费用：

1. 不能出示相符的保修卡和有效购买凭证情况的，
2. 未按使用说明告知的使用方法和注意事项造成的故障，
3. 自行拆卸、维修、改装所造成的故障和损坏，
4. 由于不可抗力等外部原因引起的故障和损坏，
5. 由于运输、搬运、挤压等造成的损坏。

对于保修期外或不在保修范围内的产品，如需维修，摩恩将酌情收取上门费、人工费及材料费。

本保修条款仅对原始消费者和酒店行业的购买者有效，并不适用于本产品工业、商业、贸易和非酒店行业的使用。

如对本保修条款内容有任何疑问，请拨打400 630 8866 咨询热线，或向当地分销商咨询。

MOEN LIMITED WARRANTY

We offer limited warranty and lifetime maintenance for Moen products, which are all manufactured with high standards of workmanship.

The period of warranty shall start from the date of purchase of the product (according to the invoice or receipt issued by Moen distributors) and shall cover a period of the following: the warranty period for shower bar is 1 year.

This warranty is your coverage against material and workmanship malfunction or defects in Moen products or components. During the warranty period, we offer free maintenance and changing of malfunctioned products or product components. Moen's after sales service liability is limited to the maintenance of faulty items and does not cover your other losses caused by product malfunction, except for otherwise stipulated by law.

Cosmetic damages (scratches, dents, etc.) and malfunction or defects caused by abuse or improper maintenance is not covered by this warranty. Although the warranty period remains valid, in case of the following conditions (1) - (5), the maintenance cost (material cost and labor cost) shall still be charged as the case may be:

1. Corresponding warranty card and valid invoice cannot be presented;
2. Faults were caused by the incompliance with the instructions and precautions provided in the user's manual;
3. Damages and faults were caused by self-actuated dismantling, repair and refit;
4. Faults and damages were caused by external factors such as force majeure;
5. Damages were caused by transportation, unloading and extrusion, etc.

This warranty is valid for the original consumers only (including hotel use), and excludes industrial and commercial use of the product (except for hotel use). This card is only responsible for product maintenance rather than any other liabilities.

In the event that the product requires maintenance but exceeds the warranty period, or that the product is not covered by this warranty, labor cost and material cost shall be charged as the case may be.

Please call 400-630-8866 or contact local dealer for any question.

MOEN® 摩恩

合格证 Compliance Certification

产品名称 淋浴杆
Product Name Shower Bar

检验员
Inspector

生产日期
Date of Production

富俊汇赢科技（上海）有限公司
中国（上海）自由贸易试验区新杨公路
1800弄1号4幢207室
邮编：201413

Fortune Brands Innovations (Shanghai) Co., Ltd
Room 207, Building 4, No.1, Lane 1800, Xinyang Highway,
China (Shanghai) Pilot Free Trade Zone